

# Woodworking Plans

## “Limbert” Wastebasket (using common building materials)

**Board List**  
 1pcs.: 1 x 12 x 8 ft. Pine  
 1pcs.: 2 x 2 x 8 ft. Cedar  
 Material Cost: ~\$20

**Cut List**  
 Sides: 2pcs.:  $\frac{3}{4}$  x  $11\frac{1}{4}$  x 20  
 2pcs.:  $\frac{3}{4}$  x  $9\frac{3}{4}$  x 20  
 Bottom: 1pcs.:  $\frac{3}{4}$  x  $9\frac{3}{4}$  x  $9\frac{3}{4}$   
 Posts: 4pcs.:  $1\frac{1}{4}$  x  $1\frac{1}{4}$  x  $20\frac{1}{2}$

- Instructions**
1. Cut and sand all 9 boards.
  2. Cut handle-holds using template and plunge router.
  3. Assemble using wood glue with tight clamps.
  4. Glue posts to make bottom planar, avoid rocking.
  5. Apply natural stain, sealer or primer of choice.
  6. Finish with several coats of polyurethane or paint.

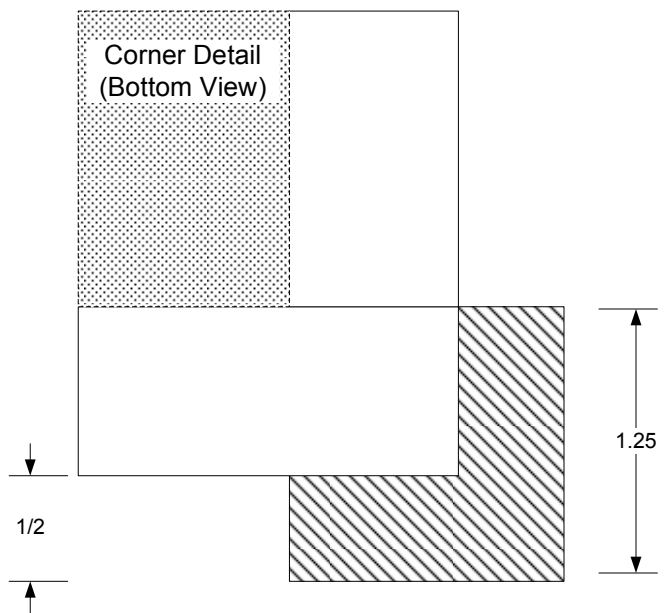
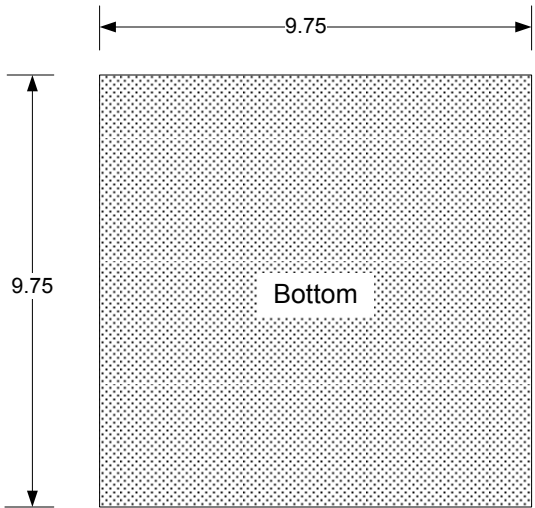
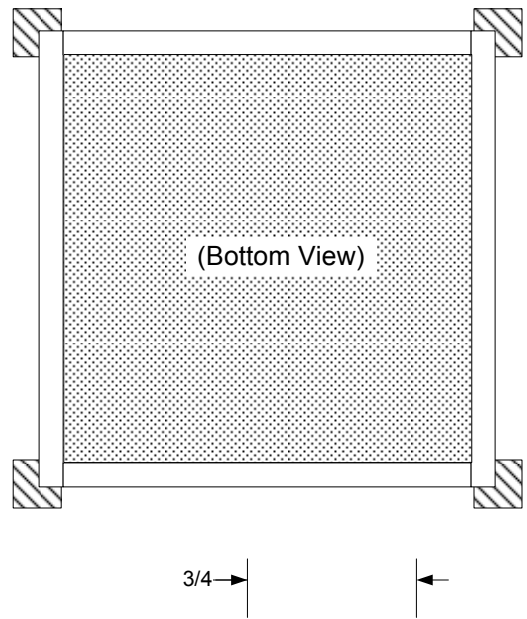
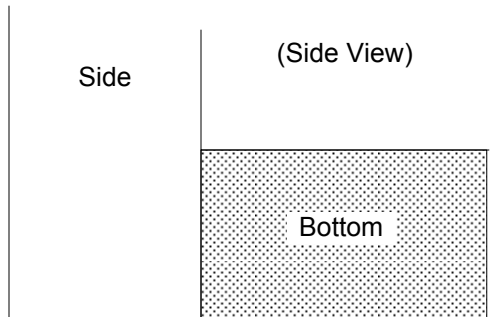
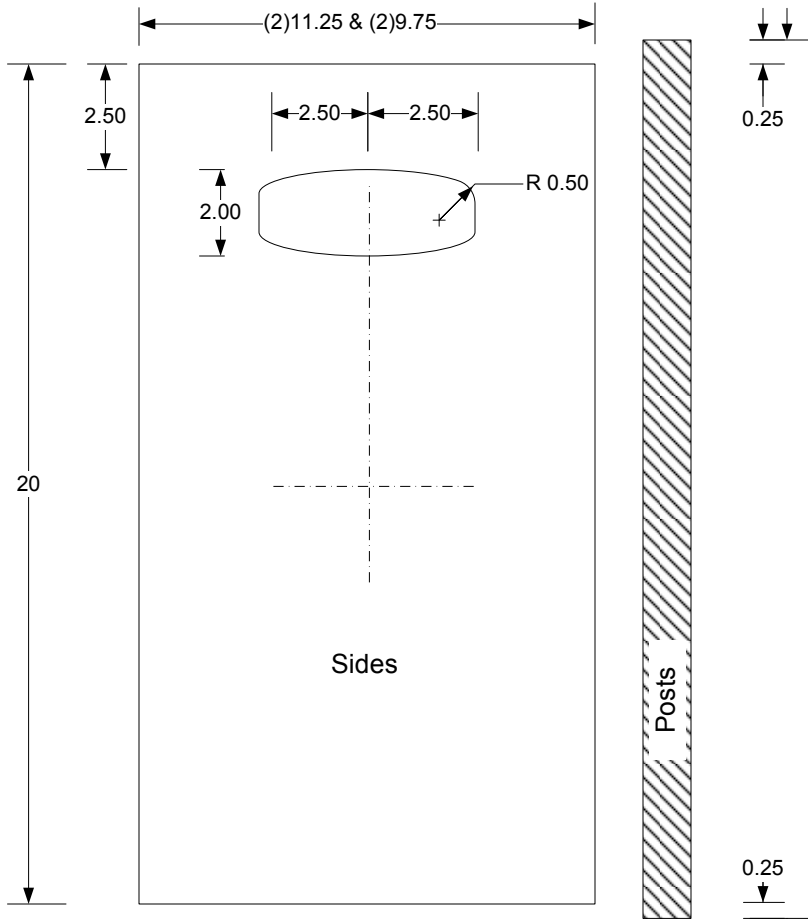

Note: Drawing not to scale  
 All dimensions in inches